

SITE PLAN AT PREMISES NO.- 106, ROYPUR, WARD NO.- 101, BOROUGH NO.-XII, P.S.- PATULI, KOLKATA- 700084.

**AREA OF LAND:- 295.427 Sqm.
HEIGHT OF BUILDING:- 15.50 METRE**

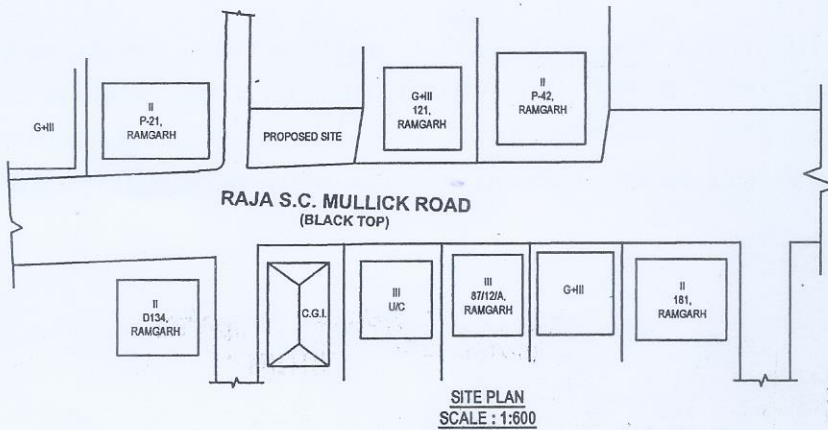
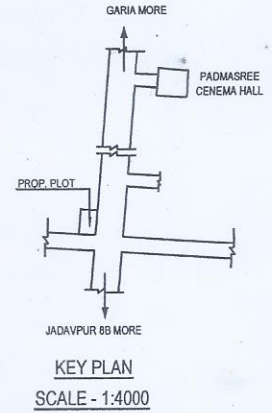
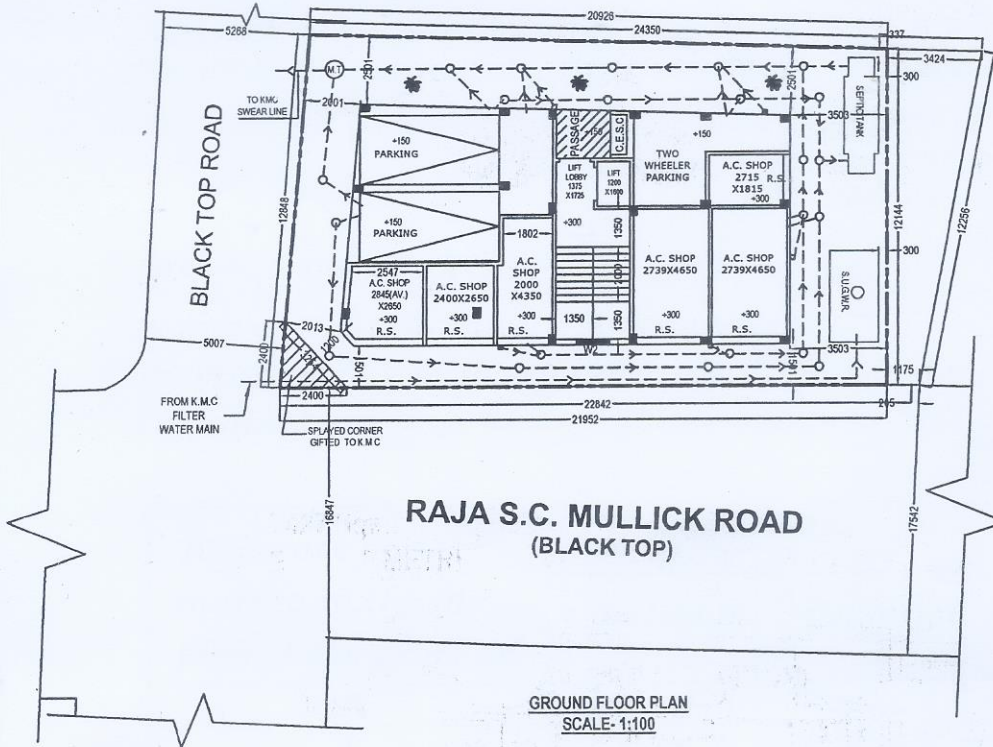

Ankita Ghatak
Ankita Ghatak
L.B.S. (Class-I) No-1535
1. Kolkata Municipal Corporation

SIGNATURE OF L.B.S.

1. *Subhas*

2. *[Signature]*

3. *Shankar Prasad*

SIGNATURE OF OWNER

Permissible height in reference to CCZM issued by AAI: 19.0 M.
Co-ordinate in WGS 84 and site elevation (AMSL):

Reference points marked in the site plan of the proposal	Co-ordinate in WGS84		Site elevation (AMSL)
	Latitude	Longitude	
A	22°28'29"N	88°22'34"E	13 M
B	22°28'29"N	88°22'35"E	13 M